

www.childrenscentralcal.org

9300 Valley Children's Place

Madera, CA 93636-8762

Child Advocacy: **(559) 353-6022**

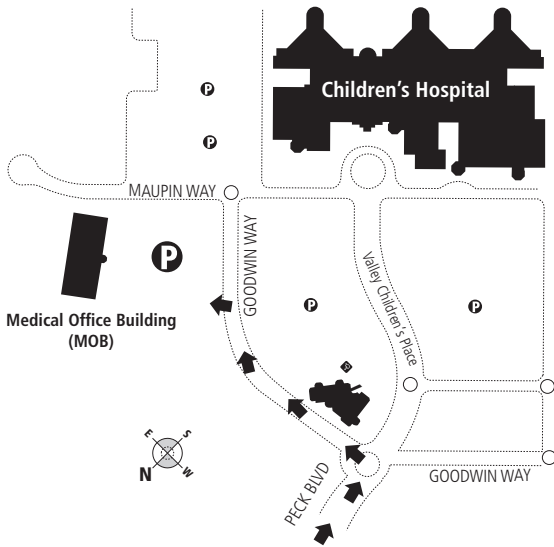

This is the Medical Office Building (MOB).

Go to the Medical Office Building (MOB) located north-east of the Hospital. It is on your left as you drive in.

1 Your appointment is on the First Floor

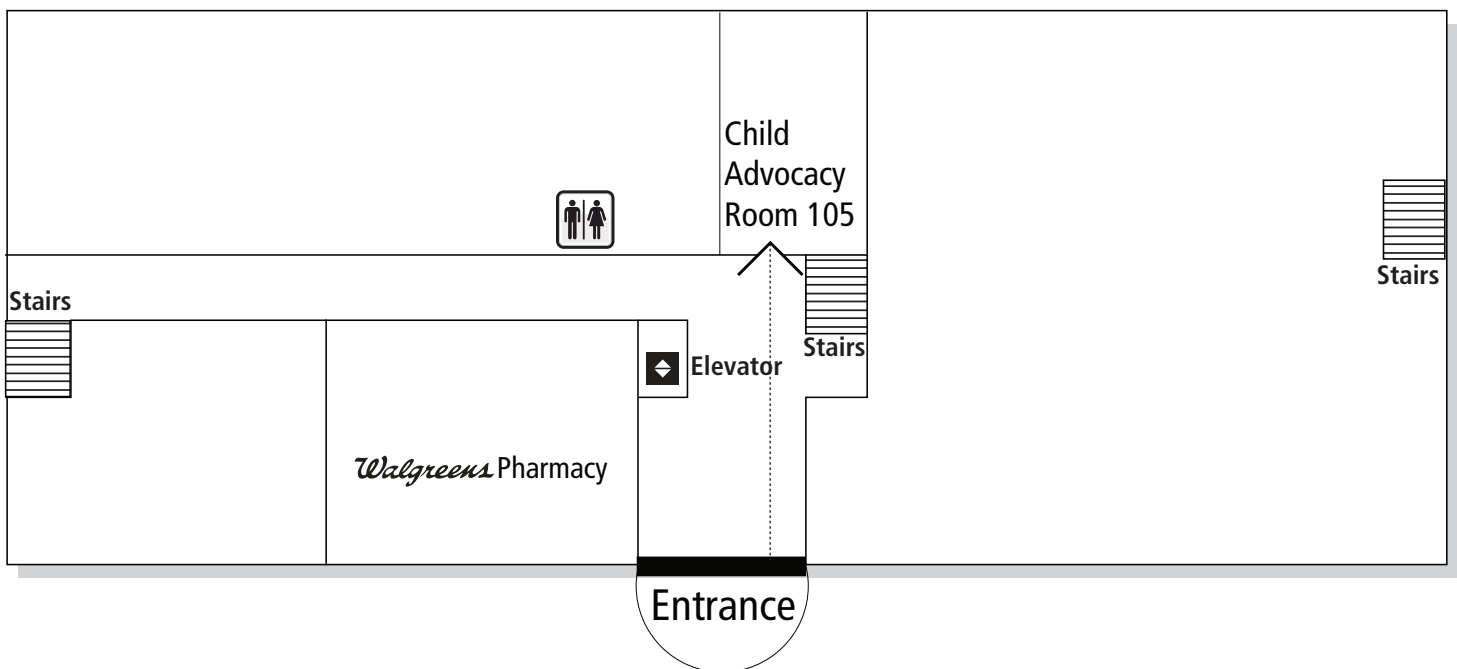

Enter the Medical Office Building (MOB) through the main entrance. The door to the Child Advocacy Clinic is on the back wall of the lobby.